



YZ-N800E-Z

MANUAL

EN

www.rami-yokota.com



EN







| | |
|--------------------------|------------------|
| Brand | : YOKOTA |
| Safety standard | : EN ISO 11148-6 |
| Square Drive / Hexagon | : 3/8" |
| Bolt capacity (mm) | : 6 - 8 |
| RPM | : 2000 - 4800 |
| Torque (Nm) | : 9 - 35 |
| Weight w/o battery (kg) | : 1,05 |
| mm A | : 157 |
| mm B | : 29,5 |
| Vibration level (m/s²) | : 0,89 |
| Sound level (dB(A)) | : 75 |
| Power supply voltage (V) | : 18 |

Before taking into use

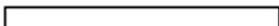
Read and understand the contents of this manual before installing, operating, repairing, maintaining, changing accessories of this tool.
Only qualified and trained operators should install, adjust or use the tool.

Charging the battery

Slide the battery in the charger, this should go smoothly otherwise the alignment isn't correct or the battery / charger grooves are damaged. In that case check the battery and charger and replace the damaged item, do not repair.
Cool down the charger when charging more than two battery packs consecutively.
Do not insert your fingers/ nails into contact hole, when holding charger or any other occasions.
Place charger in a relatively cool and well-ventilated area.
Plug charger into the AC outlet. CAUTION: Ensure that the power source to be utilized conforms to the power requirement specified on the product nameplate.
Charging will not start if the battery pack is warm. For example, immediately after heavy-duty operation. The yellow standby lamp will be flashing until the battery cools down.
Once the battery is fully charged, the green lamp will be lit to indicate the gone into a trickle charge mode.
When the battery is correctly installed, the red LED lights and charging starts. The cooling fan in the charger switches on or off depending on the battery temperature.
LED blinking green, battery is 80 % charged When the charging is complete, the LED lights green and you can remove the battery from the charger.
Battery charger LED indications:

| LED Display condition | | | Charging condition |
|-----------------------|---|----------|--|
| Color | Lighting condition | | |
| OFF |  | OFF | Condition of plugging in .. |
| RED |  | Lighting | Charge in process |
| GREEN |  | Blinking | Practical charge (80%) completed |
| GREEN |  | Lighting | Charge competed |
| ORANGE |  | Blinking | Charge standing-by (Temperature of battery pack is high/low) |
| RED |  | Blinking | Charge impossible (abnormality etc. of battery pack) |

Number of cycles per battery charge, based on maximum torque on hard joint application (0.5 seconds impulsing)
YZ-N600: 1300 cycles
YZ-N800: 800 cycles
YZ-N900: 700 cycles
YZ-N950: 650 cycles

Do not ignore safety precautions!

Safety

Do not modify this tool in any way, this can cause danger for the operator.
Make sure that this manual is accessible at all times for any relevant person, in case of loss of this manual ask your dealer for a new copy or refer to our website.
Risk of explosion or fire: Make sure that generated sparks and/or increased temperature of the work piece can not cause any explosion or ignite a fire.
Make sure that during operation of the tool no projectiles can be generated, this can be dangerous and may cause injuries.
Make sure that the work piece is securely fixed.
Make sure that the inserted tool or accessory is mounted correctly, if not it may cause high speed projectiles.
Make sure that no dangerous circumstances can occur for other persons in the work area.
Always wear safety glasses during operation of the tool. The grade of protection must be in relation to the risk of the operation.
Rotating mounted accessories can be easily entangled by rubber coated or metal reinforced gloves. Wear suitable gloves.
Keep fingers out of reach of the inserted tool or accessory.
Never hold the drive shaft, socket, bit, inserted/mounted tool/accessory with your hands while rotating.
For impact and impulse wrenches: Only use impact sockets, see our Action catalogue.
The use of safety-/working gloves is recommended.
Use ear protection as instructed by your employer or as required by occupational health and safety requirements.
Reasonable countermeasures have to be taken to keep the noise level as low as possible.
Always check that the mounted tool or accessory is not damaged. Breakage and flying fragments can cause injuries.
Make sure that the maximum rpm of the accessory is equal or higher than the maximum rpm of the tool.
Keep rotating parts out of reach of any body part.
In case of long hair, wear a hairnet otherwise it can be trapped causing injuries.
Never wear loose clothing, wear suitable clothing otherwise it can be trapped causing injuries.
Only use accessories for this tool that are designated for this tool by its manufacturer.
Convince yourself that no persons are in the working zone or danger zone.
The advised minimum age for operating this tool is 18 years.
Keep the work place clean and organized, you may stumble and fall over a hose on the floor. Slippery floors and objects on the floor are major causes of injuries.
This tool is not intended for use in potential hazardous areas and is not insulated from coming into contact with electric power.
Wear the appropriate clothing to feel comfortable at the workplace.
On overhead work, use safety helmet.
Never let the tool run free in the air: the accessory may come loose and become a projectile causing danger or injury
Only use accessories that are in good condition, worn accessories can be dangerous and cause injuries.
Only trained and qualified operators should use the tool.
Never use a damaged tool.

Tools shall be inspected periodically to verify that the ratings and markings required by the applicable part of the ISO 11148 series are legibly marked on the tool. If not the user/employer shall obtain replacement labels from the dealer or manufacturer.

Use only tight fitting gloves, loose gloves can be trapped or entangled causing injuries.

Use the specified gloves for the application that protects against: heat, cold, entanglement, cutting, impacting

Do not wear any shawls jewelry etc that can be trapped or entangled causing injuries.

In case of power loss, release the trigger immediate.

Make the possible countermeasures to minimize noise emission: if possible, use silence materials on the workpiece or walls around the work station.

A risk assessment related to the noise emission at the work station on the work piece has to be made to determine the correct ear protection according to health and safety regulation.

A risk assessment related to the vibration exposure to determine the maximum working hours per day for the operator. Vibration can cause damage to blood vanes and nerves (white finger disease). Hold the tool with light but safe grip, higher grip force can increase vibration effects.

Electrical Safety

This product is for the indoor exclusive use. Do not use it in rain, in a damp place and a wet place. Moreover, never use it in a place with the fear of the ignition and the explosion, because those are hazardous situations.

Do not move by holding the power cord. Do not pull the cord to remove the plug from the socket-outlet.

Avoid damage of cord due to stepping, entangling, or unreasonable force, a damaged cable must be replaced immediate.

Avoid pinching of power cord in the object to be tightened or surrounding facility in the tool operation and avoid the contact with rotating parts. The power cord may be damaged and it may result in accidents.

Use the battery charger at rated supply voltage (AC 100-240 V).

Do not use DC power supply, engine generator, or power transformer.

Keep away from sources generating large electromagnetic noise, such as welder, DC brush motor.

Be sure to use the provided power supply cord. Use of other power supply cord may cause malfunction, heat generation, or fire.

Be sure to fully insert the power plug. Failure to do so may result in electric shock or fire due to heat generation.

If you do not use the product, unplug from the receptacle.

Wipe out dust or stain accumulated on the power plug or receptacle with a dry cloth. Failure to do so may result in electric shock or fire.

Do not insert or remove the power plug from the receptacle with wet hand. Doing so may result in electric shock.

Never disassemble or modify the charger.

Battery Safety

Do not disassemble or modify the battery pack and battery charger, doing so may result in heat generation, fire, electric shock, or injury.

Do not throw the battery pack into fire or heat it, doing so may result in rupture or release of hazardous substances.

Do not drive a nail or give an impact such as fall on the battery pack or battery charger. Doing so may result in heat generation, fire, electric shock, and/or injury.

Do not short-circuit the terminals of the battery pack.

Do not carry or store the battery pack with metal object such as nail. Doing so may result in smoking, ignition, or rupture.

If the battery pack gets hot during its use, stop using it immediately and contact your sales outlet or sales agent.

If the battery pack leaks, avoid contact with the substance, stop using it and contact your sales outlet or sales agent.

Charge the battery pack in well-ventilated place. While charging, do not cover the ventilation openings on the battery pack and battery charger with cloth. Doing so may result in rupture or fire.

Do not charge the battery pack at less than 0I or more than 40I. Doing so may result in rupture or fire.

Do not store the battery pack in a place reaching over 50I. Doing so may cause deterioration of the battery pack and may result in smoke or fire.

Attach an anti-short-circuit cap after the battery pack is removed from the tool or the battery charger or when the tool is not used. Failure to do so may result in short-circuit of the terminals of the battery pack and fire.

Do not expose battery cartridge to water or rain. A battery short can cause large current flow, overheating, possibly burns and even a break-down.

Do not dispose of battery packs into household waste, fire or water. Battery packs should be collected, recycled or disposed of in an environmentally-friendly manner.

If the electrolyte of the battery gets in your eyes, do not pass your hand over your eyes, but flush them with plenty of clean water and seek medical attention. Failure to do so may result in loss of vision.

If the electrolyte of the battery comes in contact with body part or clothes, rinse with a plenty of clean water and seek medical attention. Failure to do so may result in dermal inflammation or injury.

If the tool is not used for long time, fully charge the battery pack before storage. Even during storage, fully charge the battery pack at least once every six months. Otherwise, over-discharge of the battery pack may prevent it from charging.

Accessories

Only use accessories and consumables that are designed for the use with this tool.

Select the best available inserted/mounted accessories/consumables for the lowest possible noise level and vibration. Replace them in case of an increased noise level and/or vibration.

Do not use worn or bad fitting impact sockets or extensions, as this is likely to increase noise and vibration.

For impulse wrenches we advise to use "sleeve drive" sockets to minimize noise and vibration.

Make sure that the inserted/mounted tool/accessory is properly held by the retainer and make sure that the retainer is in good condition. Never use the tool without a retainer as this may cause high speed projectiles.

Use the inserted/mounted accessory/tool according to the manufacturer specifications.

Only use impact rated sockets when using impact or impulse wrenches.

Using the tool:

Before start using the tool, make sure that you are familiar with the workplace and surrounding area.

Always obey the safety regulations for the work area you are working in.

During operating the tool, the operator may be exposed to hazards as crushing, impacts, heat, vibration, cuts, abrasions, etc: Wear suitable gloves.

Any person handling the tool must be able to handle the size, weight and power of the tool.

Always be prepared for normal/abnormal movements/forces generated by the tool.

Keep your body in balance, place your feet safe and secure.

When using a power tool, you may experience discomfort in your hands, arms, shoulders, neck and other parts of your body.

If you experience symptoms such as persistent or recurring discomfort, pain, throbbing, aching, tingling, numbness, burning sensation, or stiffness: Do not ignore these warning signs. Stop using the tool, tell your employer and consult a qualified health professional.

Check if the direction of rotation is in the required direction.

Adjust the torque according the requirements for the application, see below paragraph: Adjustments.

Place the tool with the accessory on the bolt/nut screw.

Pull the trigger to start the tool and release the trigger to stop the tool.

Push the lever to start the tool and release the lever to stop the tool.

Do not overtighten the bolt/nut/screw, a broken part can become a projectile causing danger or injury.

When loosening the bolt/nut/screw may become a projectile causing danger or injury.

Operator should change posture regularly to avoid discomfort and fatigue.

Use hear protection according to employer, health and safety regulations.

Standby / working mode

After inserting the battery the tool will be in standby mode, pull the trigger once to switch into working mode. Take note that the tool will rotate pulling the trigger in standby mode.

After pulling the trigger the LED on the grip will light according to the speed setting and the fan will be activated. The tool returns to standby mode after 15 minutes of no use.

Torque Adjustment

Always disconnect the battery before adjusting the torque.

The torque output adjustment is a combination of the relief valve setting and speed setting.

Relation between relief valve setting and speed setting.

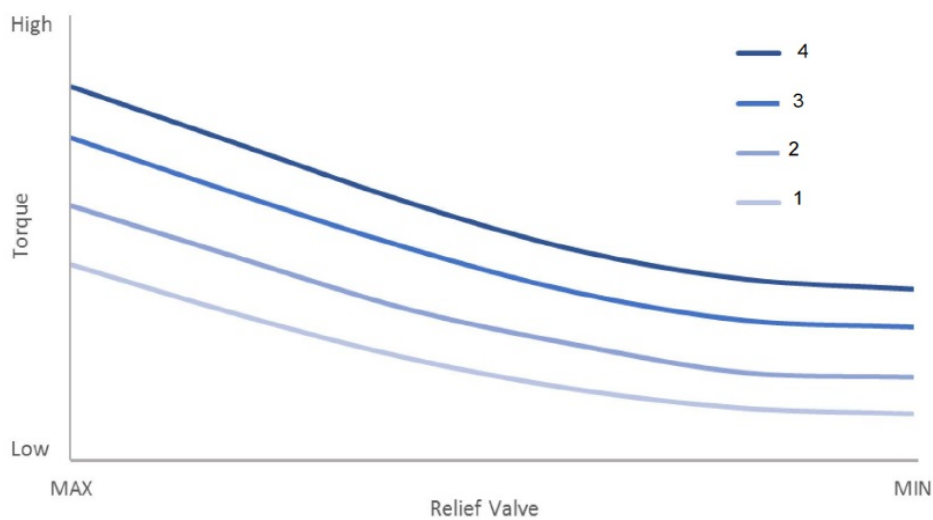

1. Speed setting 1
2. Speed setting 2
3. Speed setting 3
4. Speed setting 4

Setting the motor speed, rpm

On the left handle side is the rpm setting screw

1 = 2000 rpm, LED blinks 1 time

2 = 3000 rpm, LED blinks 2 times

3 = 4000 rpm, LED blinks 3 times

4 = 4800 rpm, LED blinks 4 times



Adjusting the torque by the relief valve.

Use the TF pin supplied with the tool in the box.

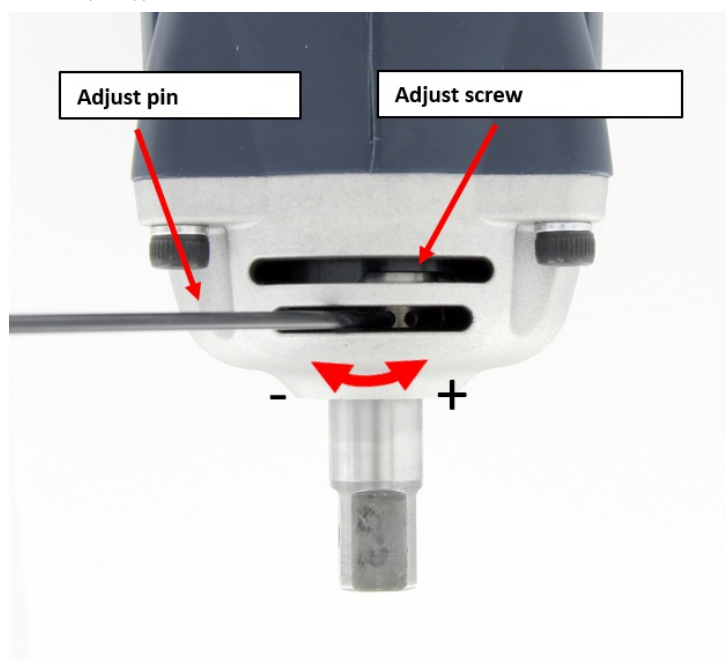

The adjust screw is blocked in both directions, never use force or otherwise the screw or internal parts may get damaged.
Never use the tool at 100% at its maximum or minimum.

Maintenance:

Check the tool regularly for loose bolts/screws or parts.
In case of power loss: Have the tool repaired.
Only trained and qualified engineers are allowed to adjust or repair the tool.
In case of disposal of the tool, follow local regulations, so as much as possible can be recycled. Do not throw it in the normal waste bin.
The tool should be maintained regularly to minimize the noise emission and occurring vibration.
Maintain the tool at least yearly.

ERROR Mode: Display by LED

LED lighting pattern at Error or alarm.

| Condition | LED Lightning/Blinking pattern | |
|---|--------------------------------|---|
| Communication Error | 2 times blinking | Inspection / repair of the tool is necessary. Please send the tool to our company or our certified service shop for repair. |
| Motor lock error | 5 times blinking | |
| Wire breakage in motor temperature sensor | 6 times blinking | |
| Wire breakage in driver temperature sensor | 7 times blinking | |
| Over-voltage error | 8 times blinking | |
| Over-current error | 9 times blinking | |
| Speed setting error | 10 times blinking | The speed setting switch is set to the intermediate position of the adjacent setting. Please remove the battery pack and set the speet setting switch setting to the correct position. |
| Low voltage error *1 | 11 times blinking | Please replace the battery pack |
| Battery pack remaining amount alarm *2*3* | Continuous blinking | Please replace the battery pack |
| Overheat alarm *3 | Lighting | Please wait until release (LED lamp lights off). |
| *1: Low voltage error may operate when using a battery pack whose performance has deteriorated due to deterioration, low temperature, etc. Normally, overdischarge protection in the battery pack operates first and the low voltage error will not operate. *2 : Even if battery pack remaining amount alarm occurs, if you continue to use without replacing the battery pack, overdischarge protection in the battery pack is activated and the power supply is shut off. *3 : Even if the tool stops due to overheating while the battery pack remaining amount alarm is generated, LED keeps high speed blinking and will not be lit. < The tool does not operate until the overheat status is released.> | | |

Motor Overheat

The motor of the tool might overheat at intensive use. This overheat is depending on the tools adjustment (speed and relief valve) and the application, hard joint or soft joint.
At maximum torque output on hard joint application (0.5 seconds impulsing) the models can make at least the number of cycles as per below:
YZ-N600: 10 cycles per minute
YZ-N800: 8 cycles per minute
YZ-N900: 6 cycles per minute
YZ-N950: 5 cycles per minute

Intended use:

The user or the user’s employer shall assess the specific use that can be present as a result of each use.
Never use the tool otherwise than the tool is designed for and as explained in this manual.
Damages as a consequence of not following this manual, or caused by incorrect use or incorrect repairs, will never be covered by our warranty and we will have no responsibility for it. We reserve the right for technical improvements, without prior notification.

Warranty

The warranty period from the date of purchase is as follows:

- 12 months on Yokota , Toku and Red Rooster tools;
- 3 months on spare parts of tools, which are repaired by us.

Warranty covers material or construction mistakes of the manufacturer, which are clearly definable. Replacement of parts or repair by an official Yokota/Red Rooster service workshop is free of charge, when the tool is covered by warranty. Freight or postage is for the account of the buyer. Damage attributable to a normal wear, overloading or incorrect use is excluded from warranty. Always consult this manual! Replacement of tools as a consequence of warranty claims is no part of the warranty arrangements.

Also claims for loss of production and/or other damages are excluded from this warranty.

Repairs under warranty can only be considered, when the tool is in its original state and it is accompanied by a copy of the purchase invoice. Warranty claims have to be made through the dealer, who has supplied the tool concerned.

Declaration of Conformity

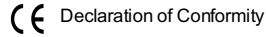

Brand: YOKOTA
Product: Impulse Wrenches
Type: YZ-N800E-Z
Capacity: 9 - 35

WE, RAMI YOKOTA B.V. , hereby declare that this product
is conform the European Directive 2006/42/EG and, the standard EN ISO 11148-6

Technical file available from Rami Yokota BV:

RAMI YOKOTA BV
De Ruyterkade 120
1011 AB Amsterdam
THE NETHERLANDS

Date: 09-03-2020 Place: Amsterdam
Signature:

N. Nauta
Managing Director RAMI YOKOTA BV

RAMI YOKOTA BV | DE RUYTERKADE 120 | 1011 AB AMSTERDAM | THE NETHERLANDS
Tel. +31-(0)20-5318800 E-mail info@rami-yokota.com www.rami-yokota.com

